



Ideas. Solutions. Products.

**DATA SHEET**

**SMARTDECK 30X30**



DESCRIPTION	
Wooden tile made of Thermowood pine with interlocking plastic base	

DATA & MEASURES	
Dimension	30 x 30 cm (1 mq = 11,1 pcs)
Thickness	2,5 cm
Material of the Base	HDPE
Material of the Surface	Thermowood®

TECHNICAL DATA		
	TEST	VALUE
PEFC certification	Valid	
Slip Resistance *	DIN 51130:2014-02	Class R10

\* Definition of the slipperiness according to the classification DIN 51130: 2014-02 ( BGR 181: 2003 ) -values range from R9 (the worst) to R13 (the best). R10 corresponds to an average value of angle higher than 10 ° and up to 19 °.

BENEFITS OF SMARTDECK
Easy to install and to remove thanks to its interlocking plastic base
Eco-Friendly plastic base made of 100% recyclable and recycled plastic
Suitable for all the project surfaces
Antislip
Made of ThermoWood ®

BENEFITS OF THERMOWOOD®	
High Dimensional Stability	
High Durability	
Mildew Resistant	
The Thermo Treatment to which ThermoWood® is subjected, is obtained just with heat and steam, without using any chemical substance	
Produced only with PEFC certified wood : the guarantee that our wood comes from areas subjected to strict rules about controlled deforestation	
ThermoWood® is Resin Free	

APPLICATION	
USE	Implementation or Restoration of outdoor floorings
IDEAL FOR	Gardens, balconies, terraces, patios, relax areas, walkways

### INSTALLATION

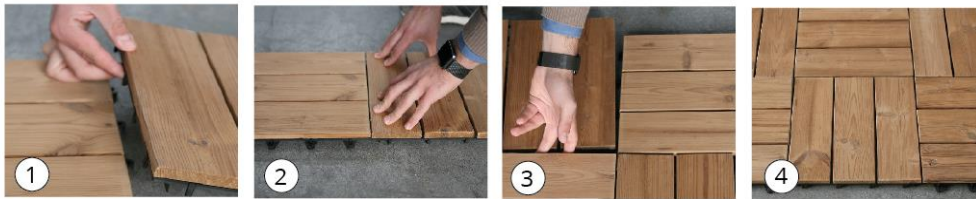

#### INSTALLATION TYPES

possible combinations with tiles of the same dimensions

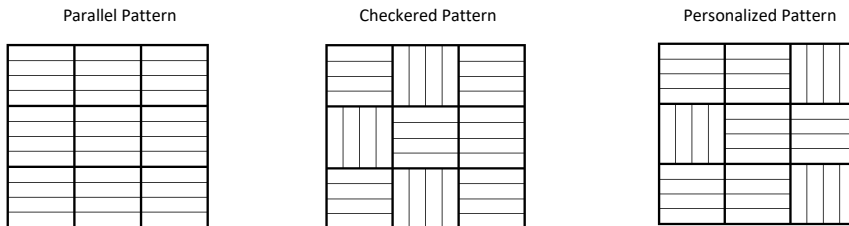

Personalized combinations with all the models of Smartdeck Line

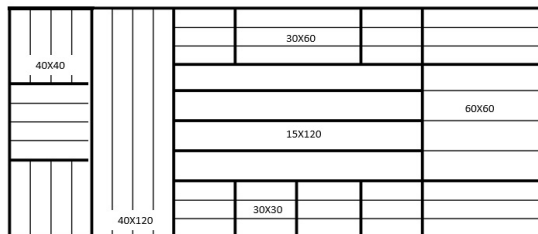

The installation is fast and easy. It does not require special tools.

1. Place Smartdeck on a rigid and flat surface.
2. Install the elements exerting moderate pressure. Proceed horizontally in rows starting from left to right and from the top to the bottom.
3. Interlock the tiles following one of the installation patterns in the image here above, until the surface is totally covered.
4. Once the flooring is installed, proceed with the appropriate treatments for the maintenance.

#### CLEANING AND MAINTAINANCE

Smartdeck, once installed, has to be treated with different products depending on the aesthetic preferences : if you want your decking to grey naturally, choose appropriate clear terrace oil/stain which slows down and makes gradual the natural chromatic variation of the wood; we recommend to apply darker appropriate oil/stain for an higher protection and a substantial slowdown of the chromatic variation.

**CLEANING:** We recommend to brush away dust and loose materials from the surface. Wash with water and a soft brush. Pressure washing is not recommended.

**MAINTAINANCE WITH OIL/STAIN:** Before the application of oil/stain (for thermowood), brush away loose materials from the surface. Carefully wash the flooring using a detergent and wait for the complete drying. If the surface is covered by a clear film due to the previous treatment, remove it before continuing, brushing gently with soft brushes (as those made of sorghum or brass) and washing again the surface (proceeding as above mentioned). Apply the appropriate oil or primer following the instruction on the product packaging. Proceed with further treatments when necessary and/or following the frequency indicated in the oil/stain packaging.

**GREYING AND RESTORING THE BROWN COLOUR:** If left untreated, Smartdeck will be subjected to the oxidation process, with a progressive chromatic variation towards grey colour: this process is faster or slower depending on the intensity of the climatic conditions to which the flooring is subjected. If the color of the surface has already turned to grey, it can be restored to its original colour by using an eligible floor cleaner liquid and/or by sanding. After that, treat again the surface with oil/stain, as described above in the paragraph "MAINTAINANCE WITH OIL/STAIN"

**BLACK SPOTS:** Impurities in the air such as soot or pollen, or metallic dust can cause small black spots on the surface. In some cases the content of sulphate combined with water can colour the wood. Black spots can be prevented by treating the wood as mentioned in the paragraph about general maintainance. In the untreated surfaces of Smartdeck, the black spots normally disappear by themselves over the time, with the natural chromatic variation towards grey tones.

The black spots can be removed by following these instructions: Carefully wash the surface using a proper detergent. Rinse and wait for the complete drying of the surface. Follow the instructions in the paragraph "MAINTAINANCE WITH OIL/STAIN".

#### MORE ABOUT SMARTDECK

- Thermowood is thermo treated to improve the durability and the stability of the wood. However slight bending or small deformation may occur even after the treatment because of the natural properties and the unique features of the wood.
- We recommend not to frame the flooring between walls and leave appropriate spaces for the natural expansion of the elements.
- If exposed to the direct sunlight, Smartdeck can be subjected to the chromatic variation. To prevent this we recommend to treat the wood with the appropriate treatments mentioned in the paragraph "CLEANING AND MAINTAINANCE".
- Smartdeck must be placed on a plain and rigid surface.

In case of discrepancies between the language versions of the data sheet, the Italian language version prevails

#### Pontarolo Engineering Spa

Via Clauzetto n° 20 Z.I.P.R. - 33078 San Vito al Tagliamento (PN) - Italy | T. +39 0434 857010 | F. +39 0434 857014 | info@onek.biz | www.onek.biz